



VAC-CON

MORE **POWER** TO YOU



3.5 YARD V-230
COMBINATION MACHINE

VAC-CON POWER
AND QUALITY
IN A SMALLER,
MORE ECONOMICAL
PACKAGE

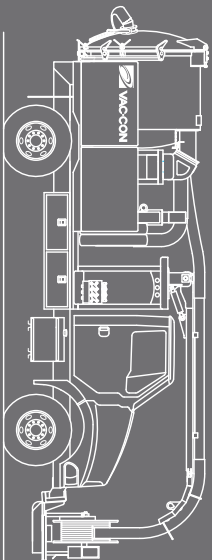

3.5 YARD V-230 COMBINATION MACHINE

MINIMUM CHASSIS REQUIREMENTS

210 HP Diesel Engine
Manual or Automatic Transmission
10,000 lb. Capacity Front Axle
17,500 lb. Capacity Rear Axle
108" Cab to Axle (CA) Dimension
Clean Frame Rails (back of cab)
50 Gal. Fuel Tank

DEBRIS TANK

Capacity: 3.5 Cubic Yards (2.68 Cubic Meters)
Material: 3/16" Corten Steel w/ 5 yr Warranty
Rear Door: Full Opening
Dump: 50° Angle
Drain: 5" Butterfly Valve with 10' Lay Flat Hose
Shut Off: Stainless Steel Float Balls

VACUUM COMPRESSOR

2-Stage Centrifugal Compressor w/ 5 yr Warranty
Rating: 135" Negative Water and 0-8000 CFM
Filtration: Centrifugal Separator with Clean Out
Power Source: Hydrostatic Drive / Chassis Engine

WATER TANK

Construction: Cross-Linked Polyethylene Non-Corrosive Tank w/ 10 yr Warranty
Tank Thickness: 3/8" (9.53 mm)
Hydrant Fill Hose Diameter: 2-1/2" (63.5 mm)
Hydrant Fill Hose Length: 25' (7.62 m)
Additional Features: Water Level Sight Gauge, Tank Access Inspection Ports
Capacity: 500 gallons

WATER PUMP

Style: Triplex
Rated For: 40 gpm at 3000 psi (113.5 lpm / 210 Bar)
Power Source: Hydrostatic Drive / Chassis Engine

HOSE REEL

Style: 180° Manual Rotation, "Easy Tilt" for Engine Access
Location: Front Mounted
Capacity: Up to 600' x 3/4" (182.9 m x 19 mm) Hose, Up to 1200' x 1/2" (304.8 m x 12.7 mm) Hose, Up to 800' x 5/8" Hose
Controls: Pump On / Off, Vacuum On / Off, Hose Reel In / Out, Hose Reel Speed Control, Engine Throttle, Boom Joystick, Pendant Control
Gauges: Water System Pressure Gauge, Tachometer

HAND GUN WATER SYSTEM

25 ft. (7.62 m) of 1/2" (12.7 mm) High-Pressure Hose
20 gpm (75.7 lpm) at 600 psi (41 Bar)

BASIC MACHINE SPECIFICATIONS

Debris Tank Capacity	3.5 Cu. Yd.	2.68 Cu. Mtr.
Water Tank Capacity	500 Gal.	1892 L
Overall Length OAL (approx.)	28'	8.73 m
Overall Width OAW (approx.)	8'	2.43 m
Overall Height Above Ground OAH (approx.)	10'6"	3.12 m
Vacuum System Drive	Hydrostatic	
Water System Drive	Hydrostatic	
Sewer Hose	400' x 3/4" (121.9 m x 19 mm)	

BOOM

- Fully Hydraulic Extendable 5' with 180° Gear Rotation
- Dual Lift Cylinders
- 20.5' of 6" Aluminum Pipe & Clamps

NOZZLES & ACCESSORIES

- Penetrator Nozzle
- Sanitary Nozzle
- Hose Guide with Retaining Rope
- Hydrant Wrench
- Leader Hose
- Nozzle Pipe Extension

TOOL STORAGE

- Tool Box (16" x 13" x 72")
- Vertical Pipe Storage

OPTIONS

- Hydro-Excavation System
- Winter Recirculating System
- Air Purge (Requires Air Brakes)
- Hose Footage Counter
- Arrowboard / Arrowstick
- Revolving / Strobe Lights
- Hydraulic Door Locks
- Debris Tank Flush Out System
- Vacuum Breaker System
- Low Water Alarm w/ Light
- 50' Retractable Hand Gun Hose Reel
- Positive Displacement Blower (2100 CFM)
- Water Pump Rated for 25 gpm at 4000 psi (94.6 lpm / 280 Bar) includes 400' x 5/8" Sewer Hose
- Boom Work Lights
- Pump-Off / 200 gpm
- Debris Tank Interconnect
- Handheld Spotlight
- Inspector Cam
- Fan Flush Out
- Wireless Remote
- Backup Alarm
- 8" dia. Inlet & Pick Up Tubes

*Complete Selection of Nozzles Available.
Specifications subject to change without notice.*



www.vac-con.com



Search:
VacConInc



Search:
Vac-Con